

\*\*\* ALL LOCKS TO BE SUITED \*\*\*

**\*PLEASE NOTE\***  
ORDERING INFORMATION  
OVERALL ROLLING FLOOR SIZE

GENERATOR STORE c/w 180°  
HINGED DOOR, FIT CABIN  
HOOK TO SECURE IN OPEN  
POSITION. SEE SHEET 3.  
C/W LOUVERE

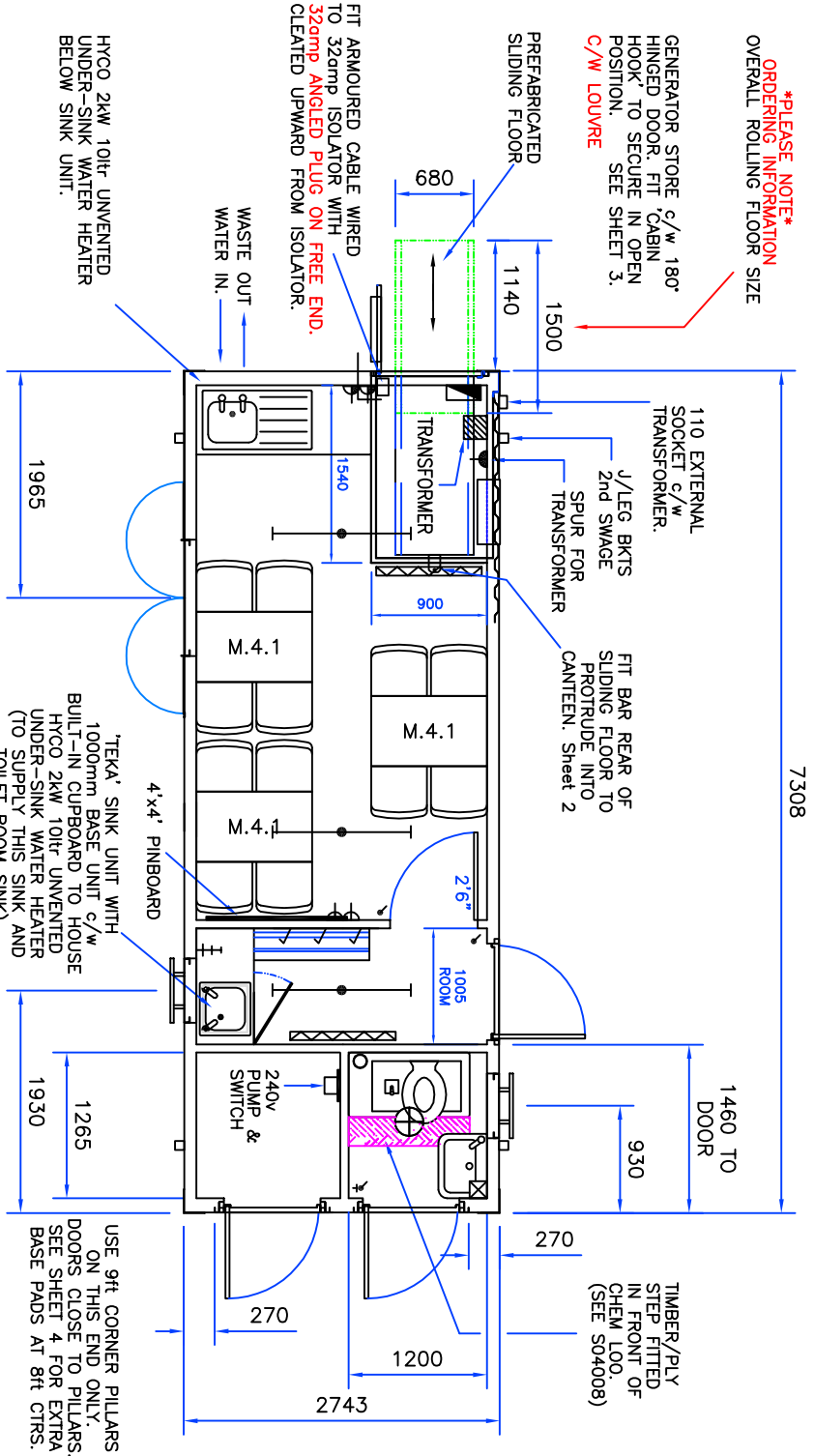

STD. 8' CORNER POSTS &  
SPECIAL BEARER POSITIONS  
SEE SHEET 2.

HYCO 2kW, 10hr UNVENTED  
UNDER-SINK WATER HEATER  
BELOW SINK UNIT.

FIT ARMoured CABLE WIRED  
TO 32amp ISOLATOR WITH  
320amp ANGLED PLUG ON FREE END.  
CLEATED UPWARD FROM ISOLATOR.

NOTE: SOCKETS TO BE WIRED AS  
RADIAL CIRCUIT (NOT RING FINAL)

END WALL BEHIND SINK, WORKTOP AND GENERATOR HOUSING PLUS FIRST  
PANEL BACK ALONG SIDE WALLS TO BE WHITE FACED 'STELVATTE' BOARD.  
REMAINDER OF UNIT TO BE LINED WITH EGG2001 & INSULATED.  
MONO WHITE CEILING PANELS AND WOODSTAIN TRIM.  
POLYFLOOR VINYL FLOORING.

- 3No 90° PERSONNEL DOORS
- 2No HIGH LEVEL WINDOWS  
c/w MESH GUARDS.
- 1No STD. 3'x3' WINDOW  
c/w STEEL SHUTTERS.

USE 9ft CORNER PILLARS  
ON THIS END ONLY.  
DOORS CLOSE TO PILLARS.  
SEE SHEET 4 FOR EXTRA  
BASE PADS AT 8ft CRS.

KEY TO SYMBOLS

	Consumer Unit
	Pullswitch
	Light Switch
	Bulkhead Light
	4' Fluorescent Light
	3kw Instant Water Heater
	Oil Filled Radiator
	Twin Skt., 300mm above F.F.L.
	Twin Skt., 1000mm above F.F.L.
	Earth Bond

**APPROVAL BOX**

Customer:  
Signature:  
Name:  
Date:

ISSUE	DATE	DESCRIPTION
1	20/08/08	FIRST ISSUE

TITLE  
Mac Containers  
Welfare Unit

**Mac Containers**

DRAWN	JT	DATE	20/08/08	DRG. No.	MAC_WU2409V01
APPROVED		DATE			
CHECKED		DATE			